

ASSEMBLY MANUAL HINGE WALA PCV AXM

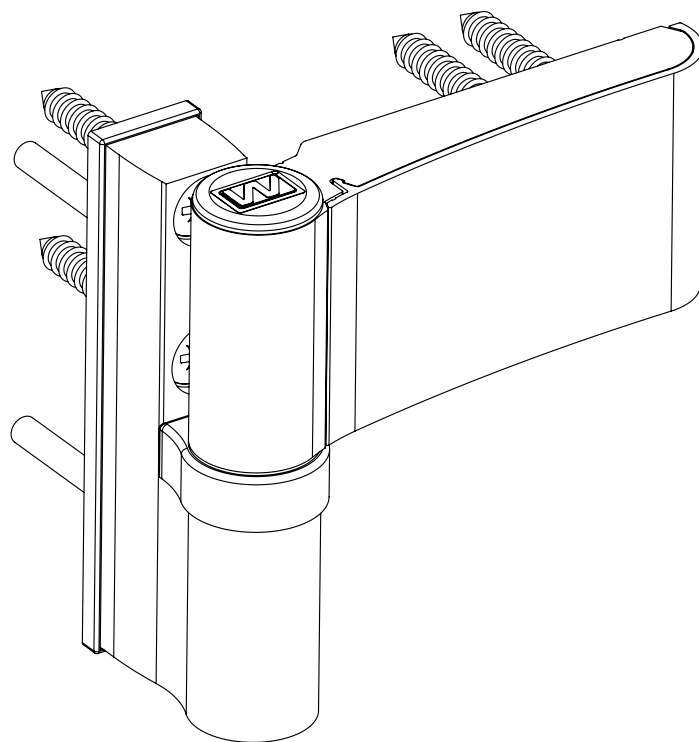
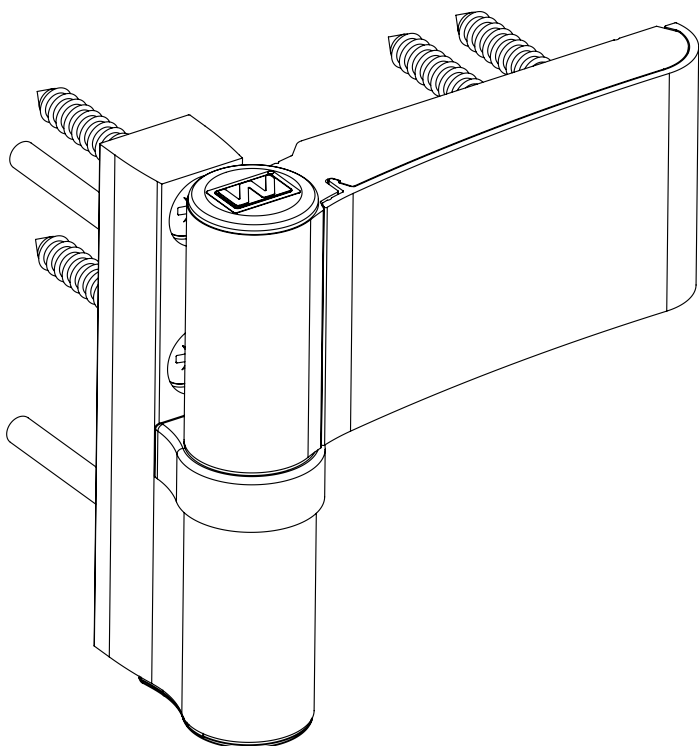

regulation ranges:

height adjustment: -1,5mm, +5,0mm

left right adjustment: $\pm 5,0$ mm

seal (upstand) adjustment: $\pm 3,0$ mm

frame assembly

A - AXM 17(...), AXM 19(...)
B - AXM 22(...)

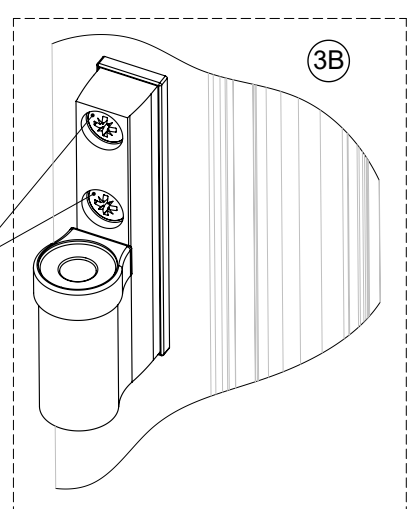
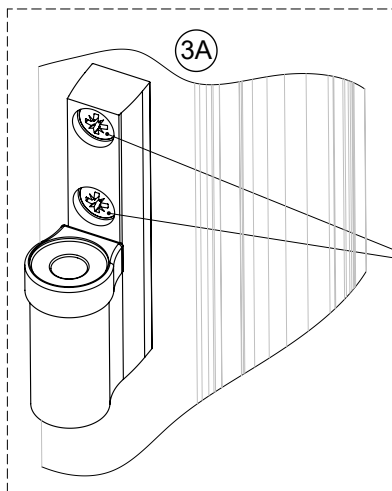
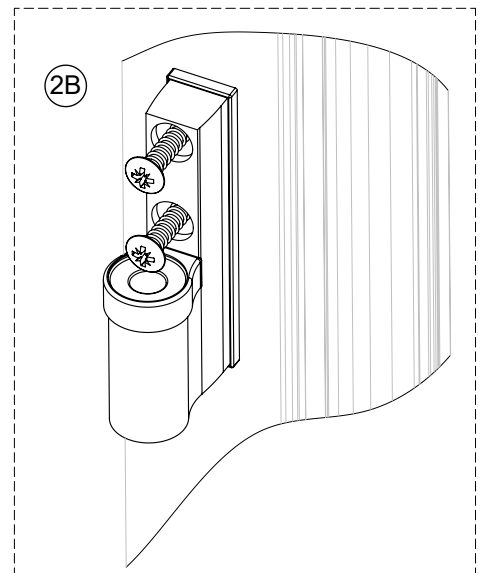
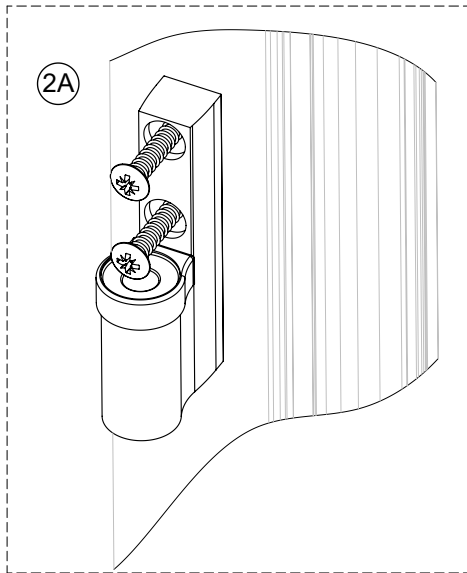
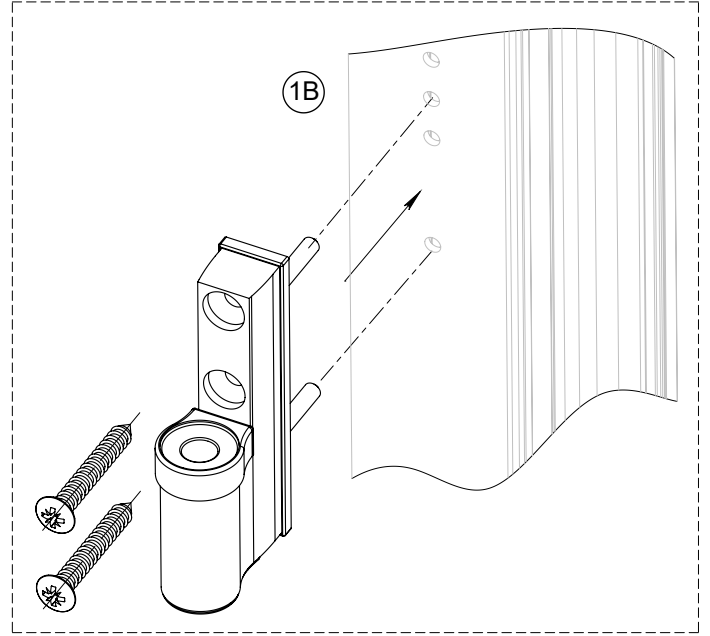
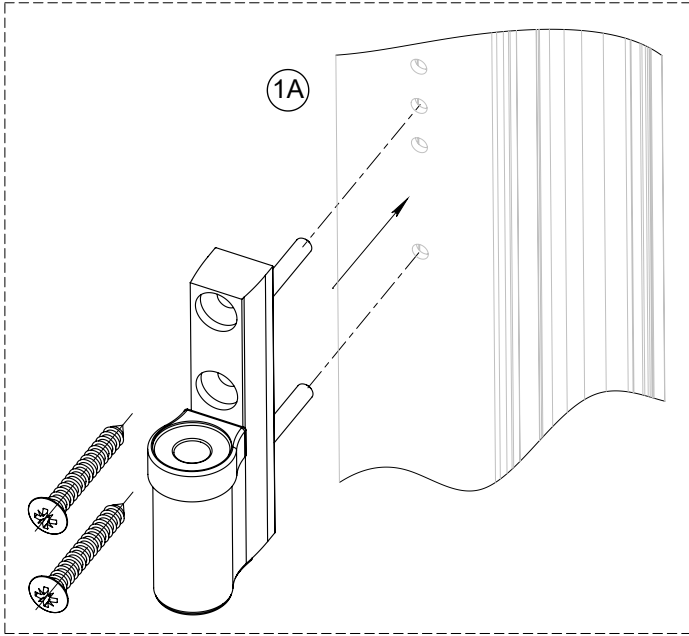

Tighten the screw carefully in order to prevent breaking the thread and deformation profile.

door profile assembly

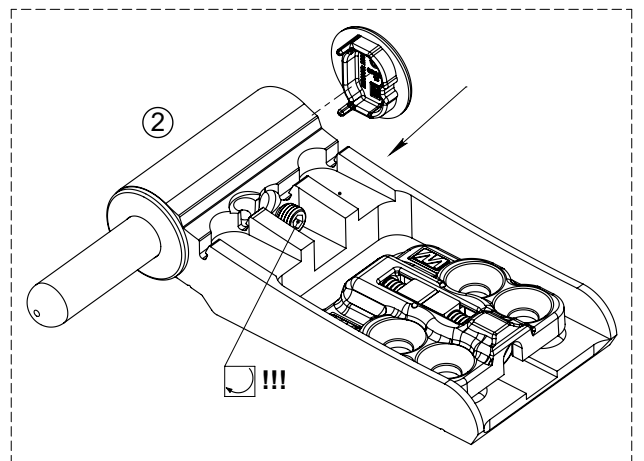
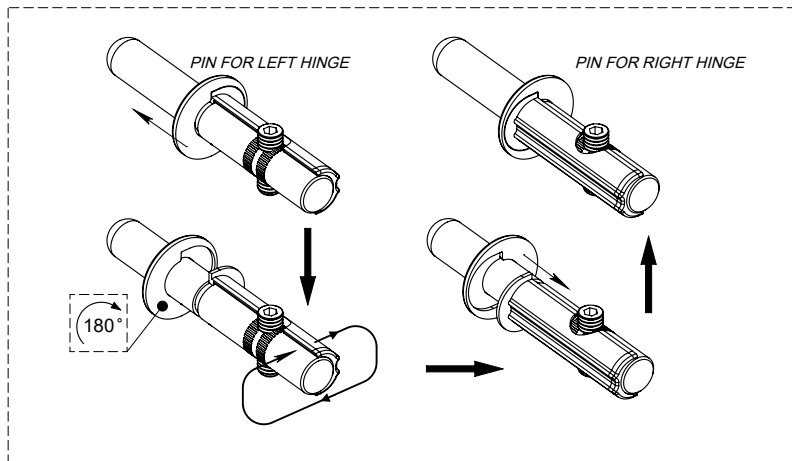
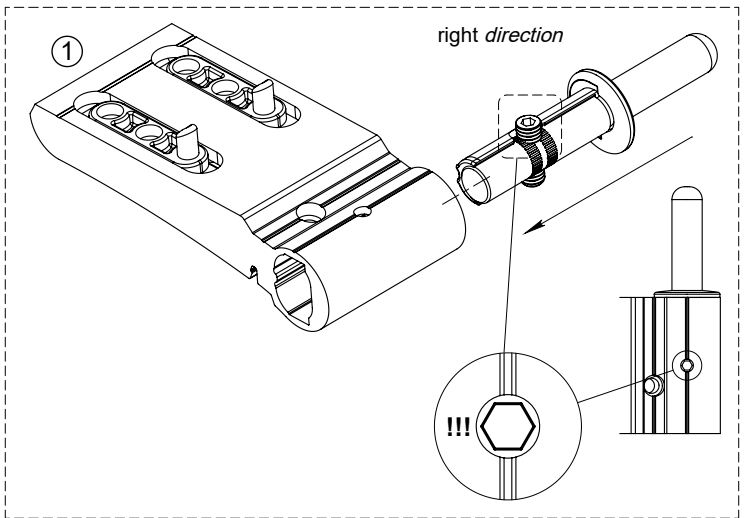
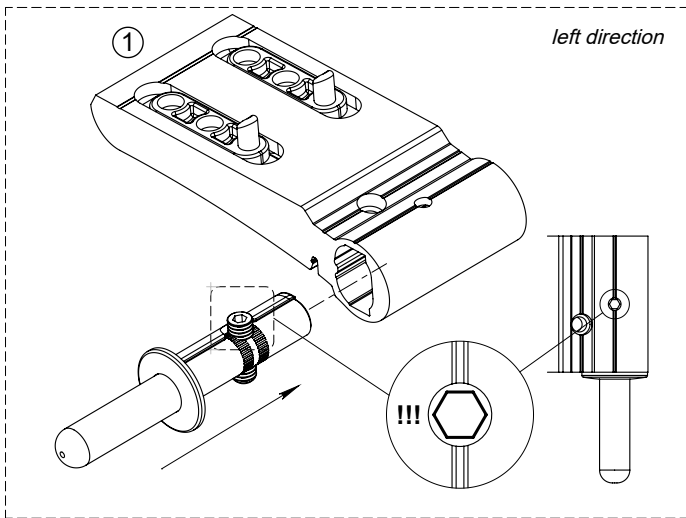

final assembly:

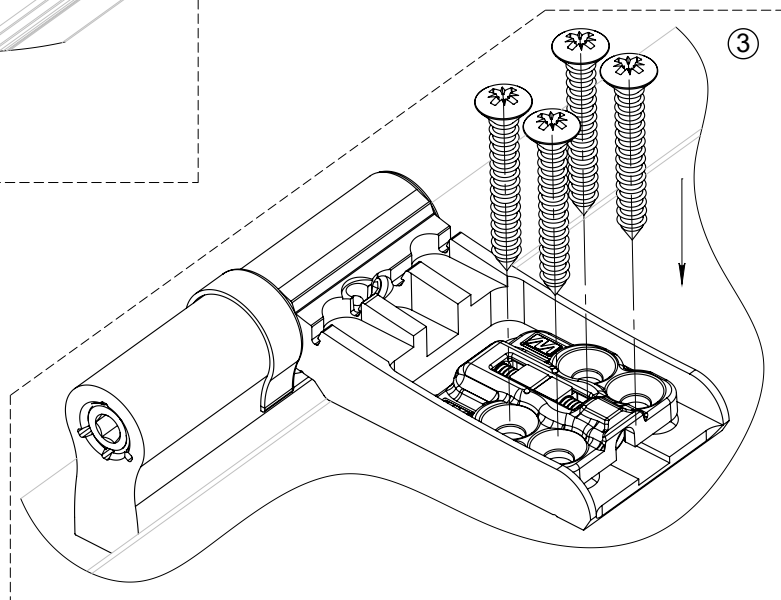
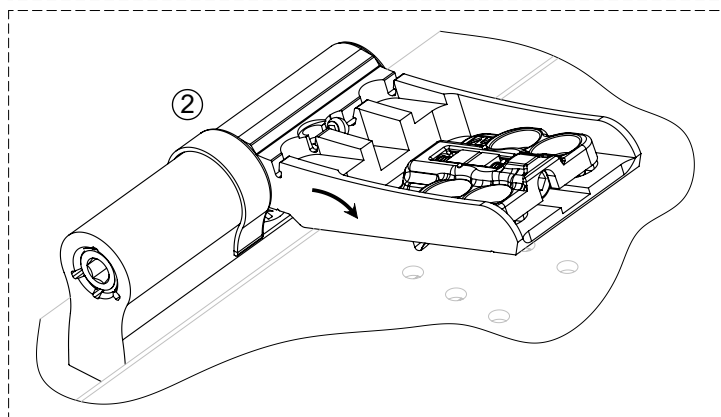
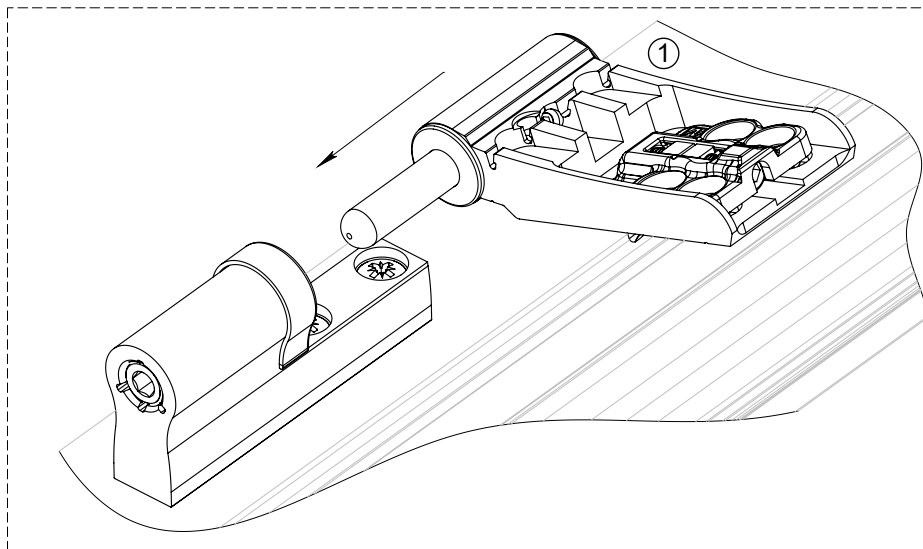

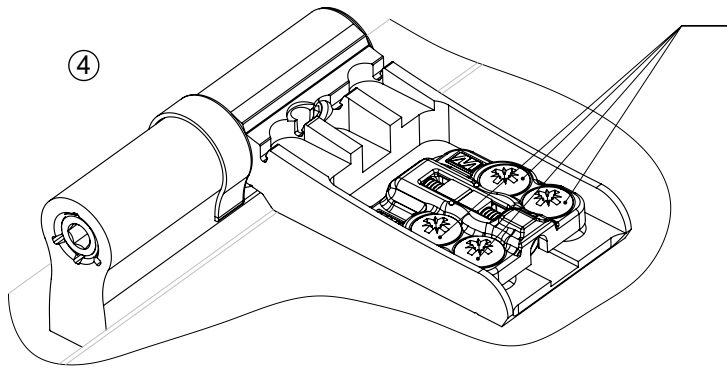

Tighten the screw carefully in order to prevent breaking the thread and deformation profile.

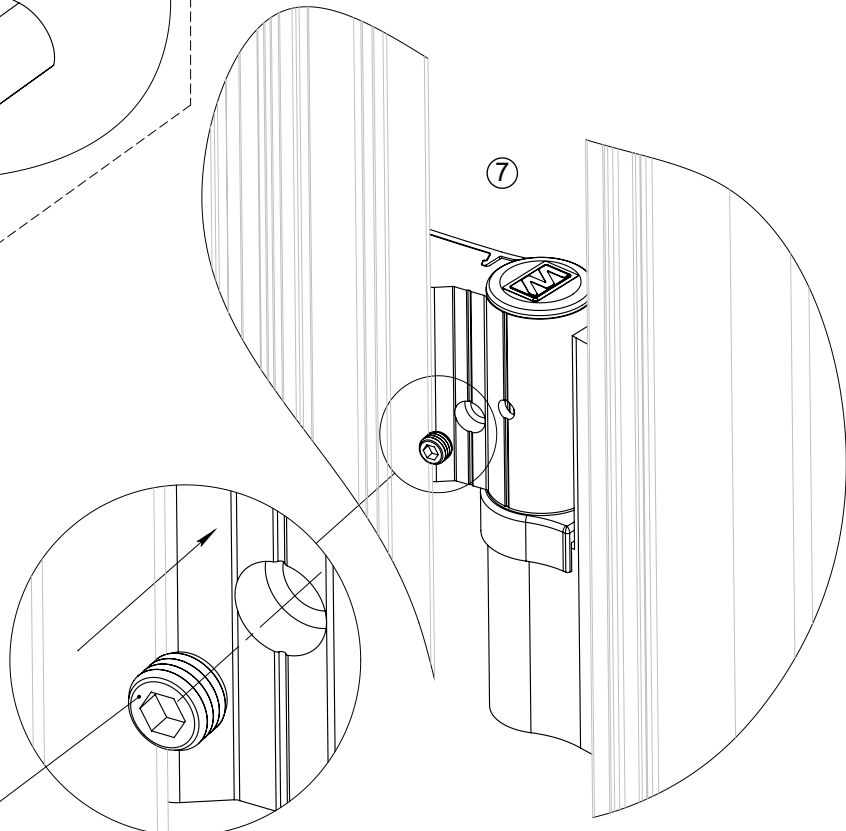
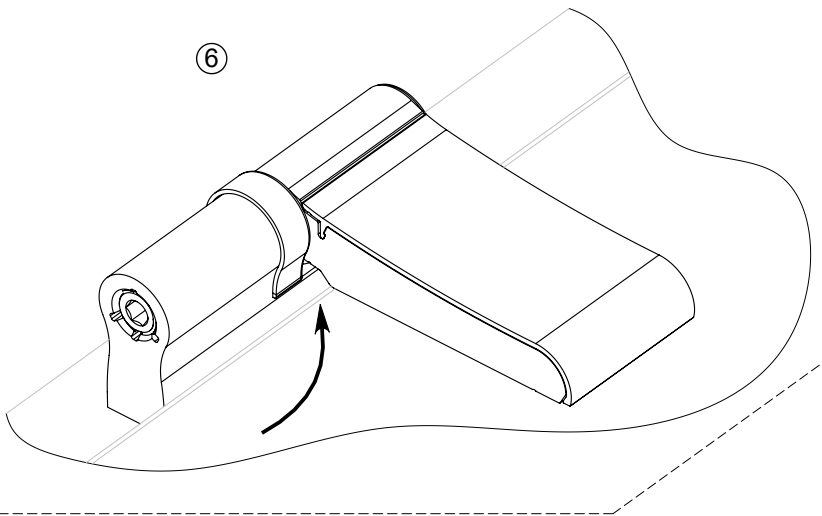
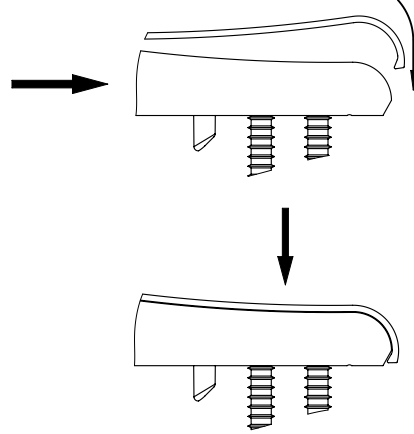
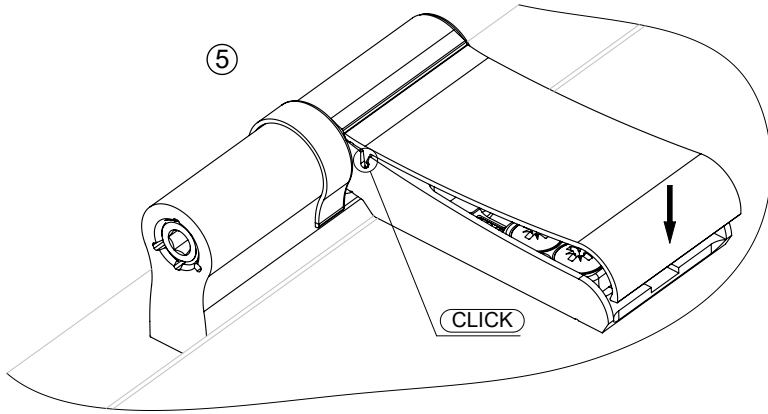

Secure the plate with the screw at open doors

MONTAGEANLEITUNG FÜR DREITEILIGES WPCV AXL SCHARNIER



After the rear wings stick pin.
Nach den Ablagerung dem Flügen ein schlagen ein Stift.

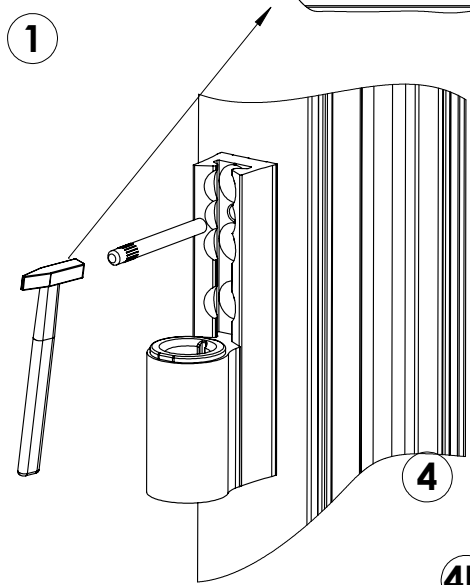

1

Tighten the screw 6-8 Nm
Ziehen Sie die Schraube 6-8 Nm

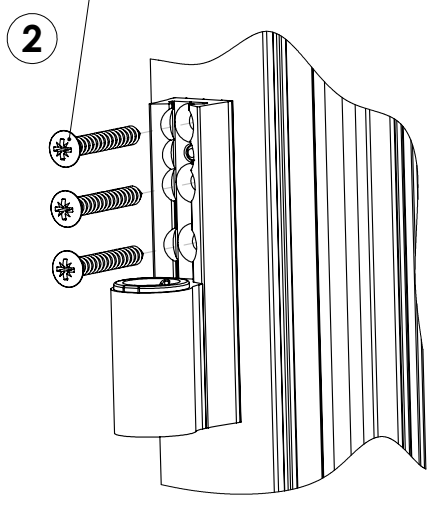

2

Put the sleeve together at the same time
with a mask
Bush legte zusammen mit Maskierung

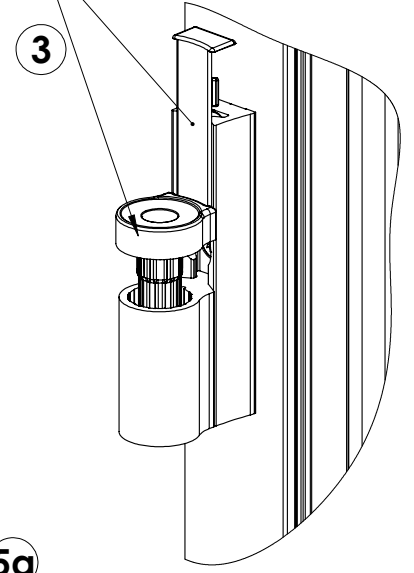

3

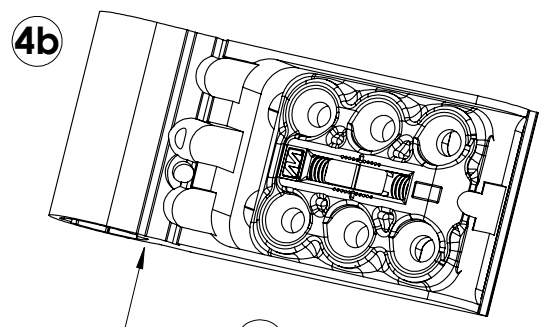

4b

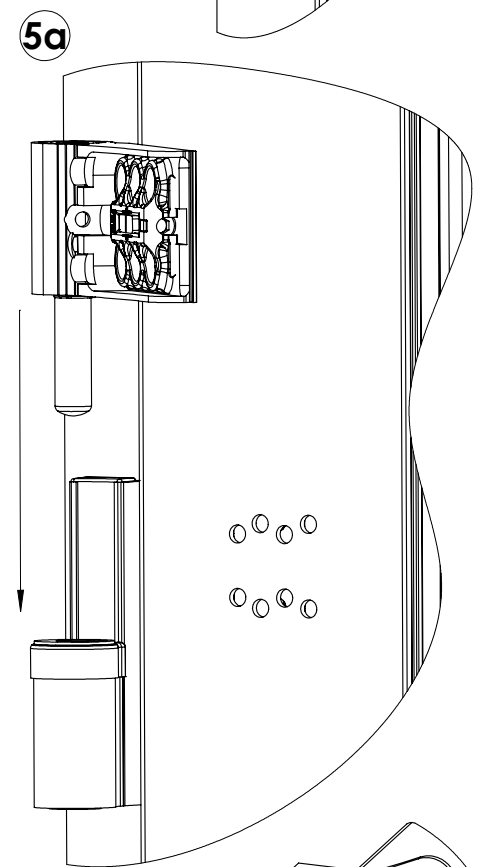

5a

4a

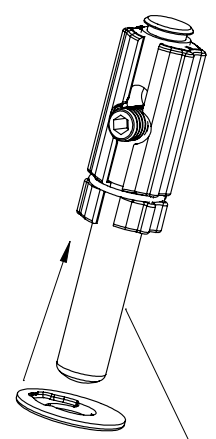

4c

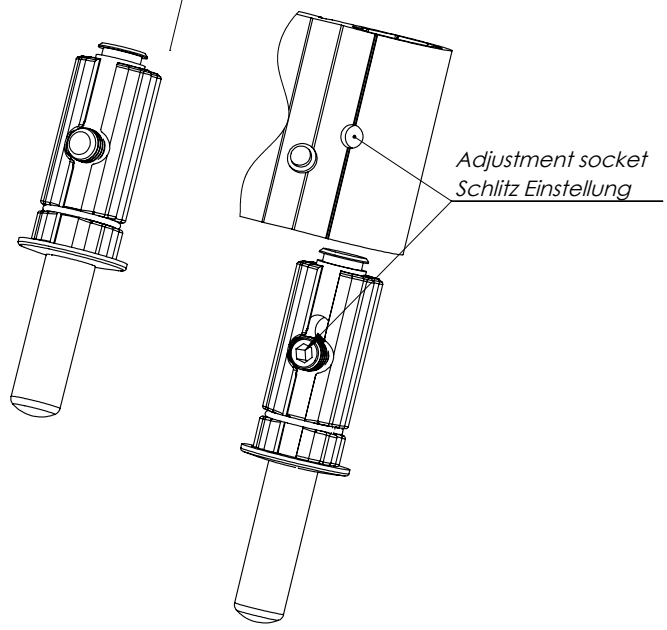

Adjustment socket
Schlitz Einstellung

CLICK!

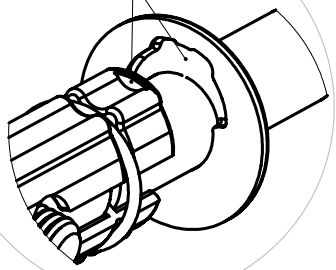

5b

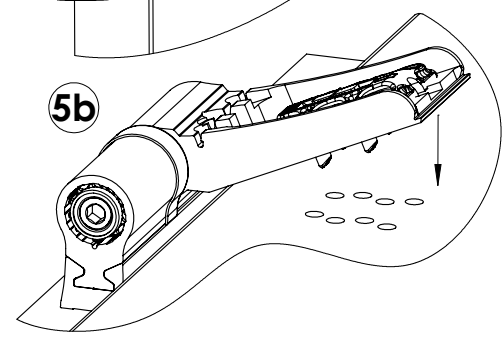

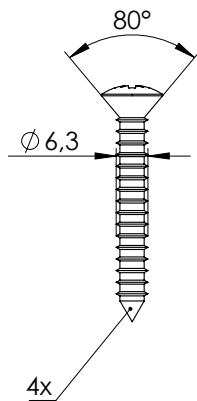
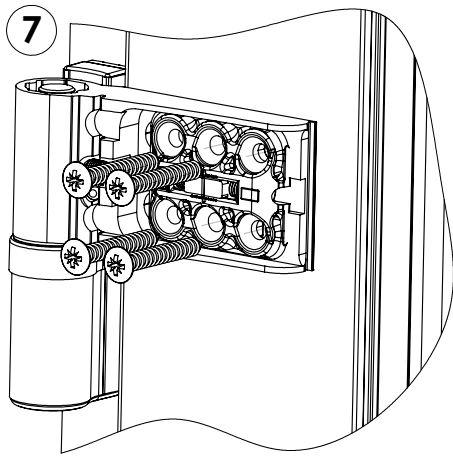

Tighten the screw 6-8 Nm
Ziehen Sie die Schraube 6-8 Nm

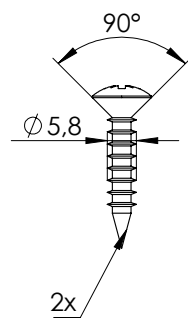
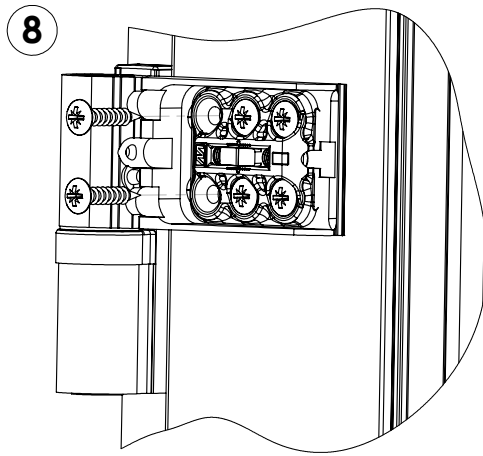

Pierwszy rząd mocowań nie przechodzi przez wzmocnienie.
Przykręcić wkręty z wyczuciem.

WARNING!

The first row of fasteners does not pass through the strengthening.
Tighten the screws with a sense.

ACHTUNG!

Die erste Reihe von Schrauben geht nicht durch Stärkung.
Ziehen Sie die Schrauben mit einem Gefühl.

9

Lock bolt assembly.
Schlossriegel Montage.

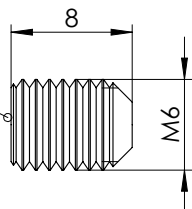
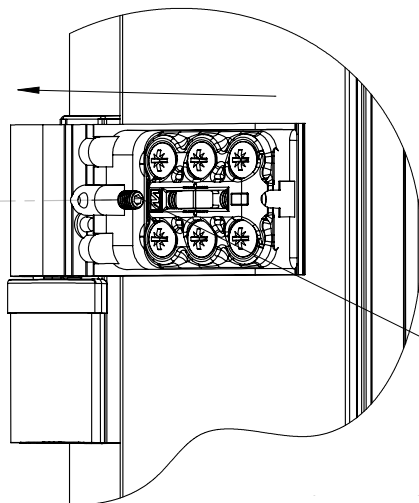

Tighten the screw 3-5Nm
Ziehen Sie die Schraube 3-5 Nm

10

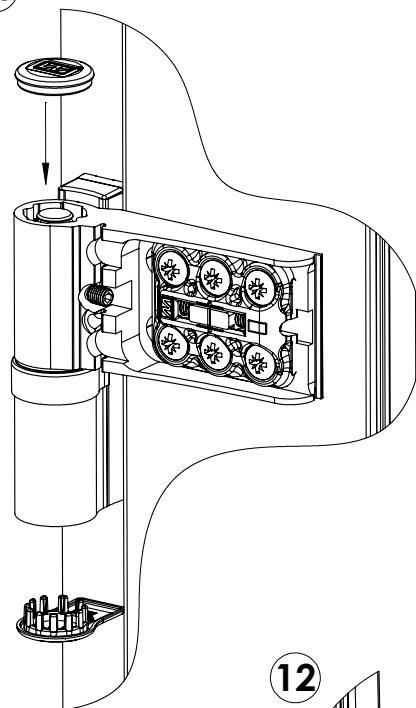

11

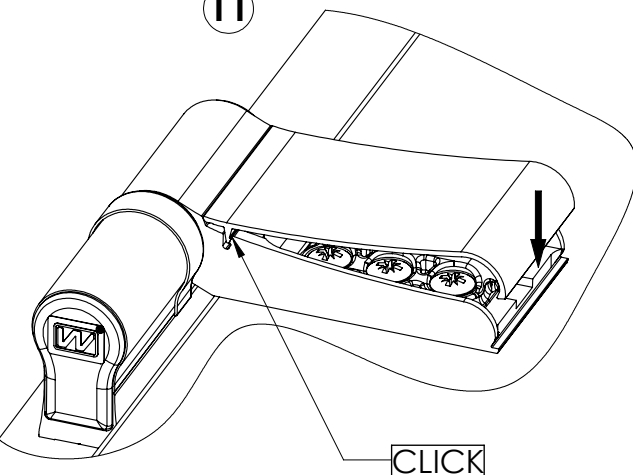

CLICK

Locking cover plate
Sperrung dic Abdeckplatte.

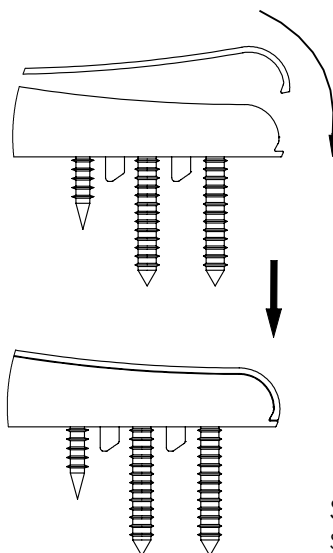

12

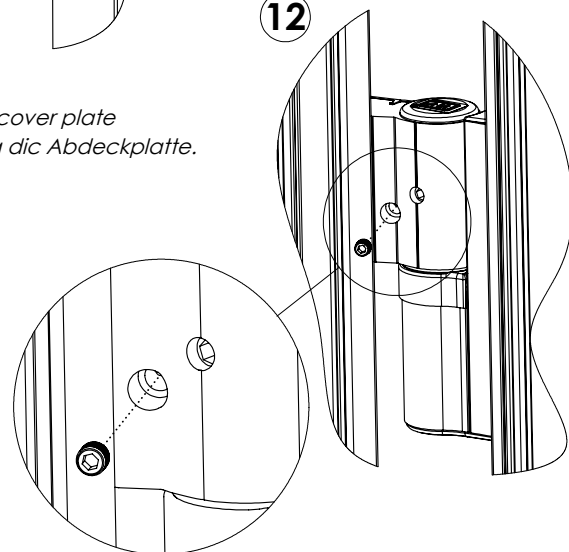

Secure the plate with the screw at open doors
Sperrung dic Abdeckplatte.

INSTALLATION HINGE WPCV AXL THREE-WINGS MONTAGEANLEITUNG FÜR DREITEILIGES WPCV AXL SCHARNIER

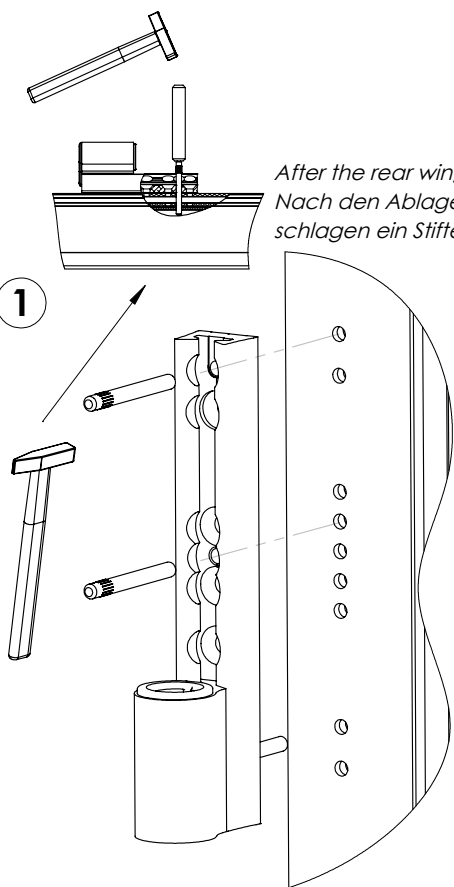

After the rear wings to knock the pins.
Nach den Ablagerung dem Flügen ein schlagen ein Stifte.

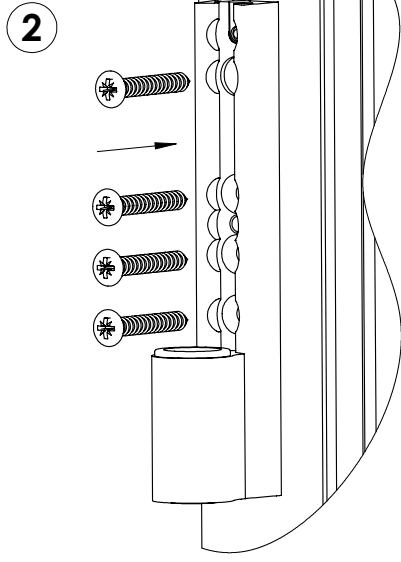

Tighten the screw 6-8 Nm
Ziehen Sie die Schraube 6-8 Nm

Put the sleeve together at the same time with a mask
Bush legte zusammen mit Maskierung

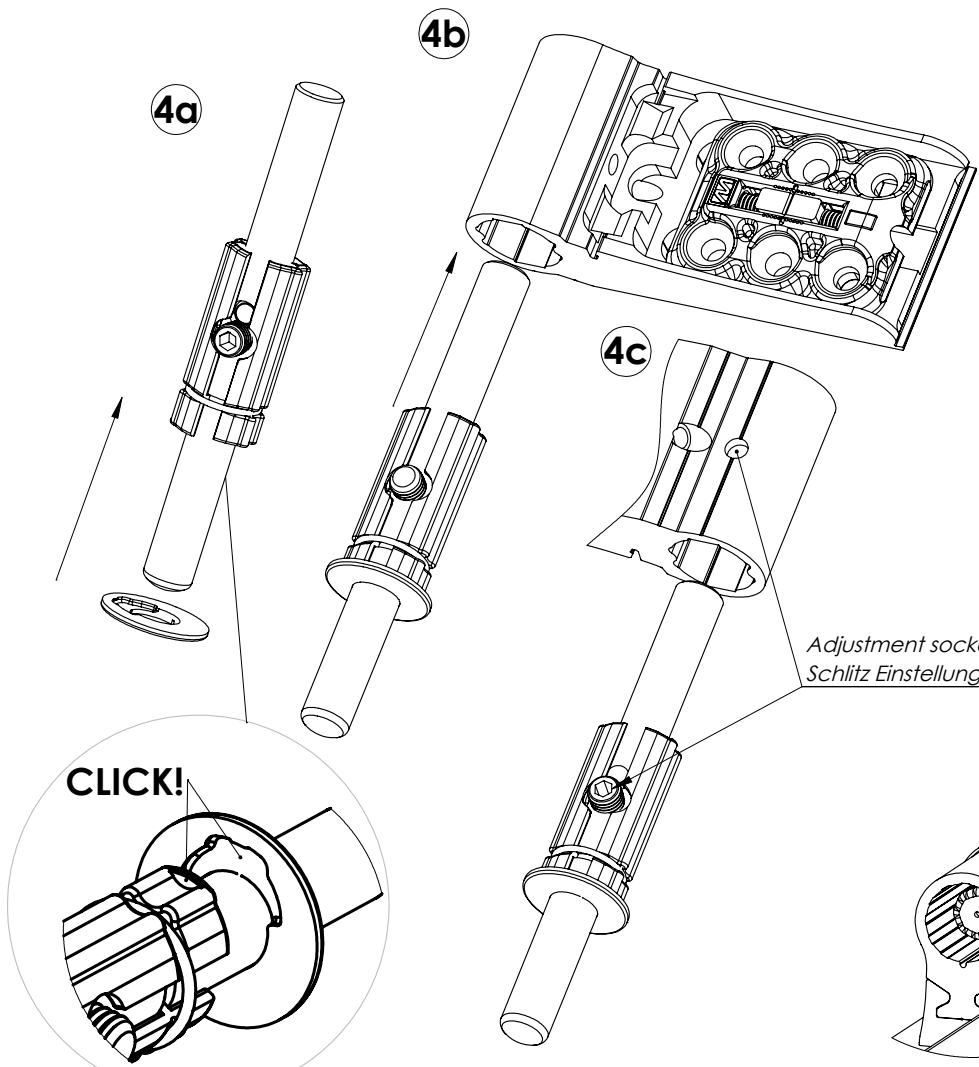
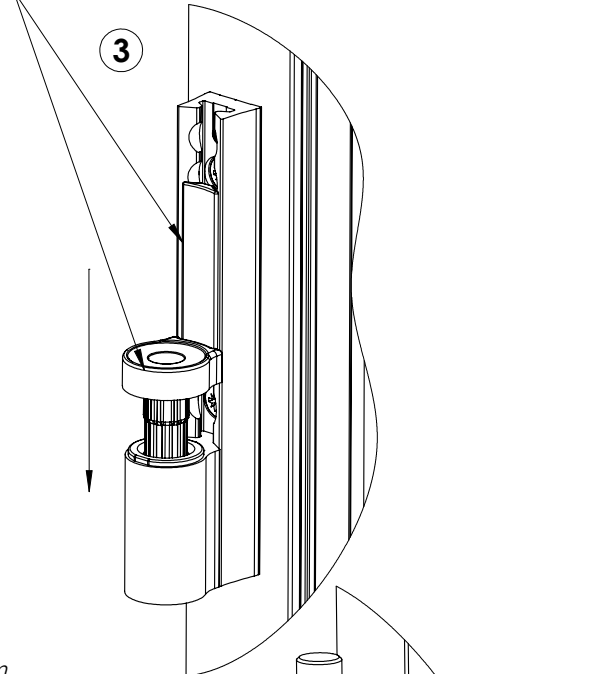

Adjustment socket
Schlitz Einstellung

